



NETBALL NEW ZEALAND
Pōitarawhiti Aotearoa

Tasman Netball

STADIUM 2000

Region: Tasman
Venue: **Stadium 2000**
Address: Kinross Street
Blenheim
Phone: 03 577 8300
Fax: 03 577 8040

Multi-purpose sports venue and events centre

Seating Capacity	
Total	1,142
Court end Mezzanine	468 each end, mobile stands 206
Restricted Viewing	Varies depending on setup
TV Setup	Towers setup for cameras Don't usually encroach on seats

Facilities – Main Stadium	
Courts	3 courts Sprung wooden floors (light natural wood colour) Mid-height curtains can be erected to screen off courts
Court Markings	Yellow netball lines 3 other coloured lines
Runoff	4.5m (entrance end) 3.05m (opposite end) 3.1m and 3.75m (to seats) 5.2m (to wall at sides) 3.9m and 5.3m between courts
Goal Posts	Sunk on all courts
Scoreboard	1 electronic scoreboard for each court
Lighting	Sufficient for TV
PA System	In-house sound system including mics Portable system available also

STADIUM 2000

Fixed Signage	No
Ceiling Height	Greater than 8.3m in all areas
Heating	Air extraction system Upright gas heaters
Courtside Media	Can be accommodated opposite score bench Telephone lines and power available on both sides of stadium plus within the floor at the edge of courts
Public Access to Seating	Ground level and upstairs entrances

Changing Rooms	
Changing Room 1 x2	1 male, 1 female Interconnecting with 2 Clothing hooks Bench seating 2 showers Mirror Heating
Toilets	Separate facility next to changing room 4 toilets
Changing Room 2 x2	1 male, 1 female Interconnecting with 1 Clothing hooks Bench seating 2 showers Mirror Heating
Toilets	Separate facility next to changing room 4 toilets

Meeting Rooms	
Mezzanine Boardroom	12 pax boardroom style Approx 25 pax classroom style Phone Internet Power Can be used as a media room
Meeting Room – Mezzanine	Small room No bathroom facilities Lockable Could be used for umpires
Studio – Mezzanine	Sprung wooden floor Used for dance or aerobic activity
Mezzanine Area	Can be used for functions Phone jack Power

Other	
Ticketing	No exclusive ticketing agent
First Aid	Physio clinic in complex
Drug Testing	Use other room in complex

Public Facilities	
Ladies Toilets	Mezzanine and 4 ground level
Men's Toilets	Mezzanine and 1 toilet, 3 urinals ground level
Disabled Toilets	Ground level
Lift	Yes
Parking	200 in complex Street parking VIP parking can be arranged with stadium
Physio	In building at the entrance Public

STADIUM 2000

Food outlets	Subway in foyer
Catering	Preferred caterers Marlborough Caterers and Continental Caterers
Gym	In foyer Public
Swimming Pool	In foyer Public
Squash Courts	At back of venue Walls are removable and can be used for functions

Notes:

- Floor protection document exists – important to read and abide by this
- Full technical specifications document available on request



Staff car parking area

- █ Common (access) Area
- █ Leased Area
- █ Wall for Signage

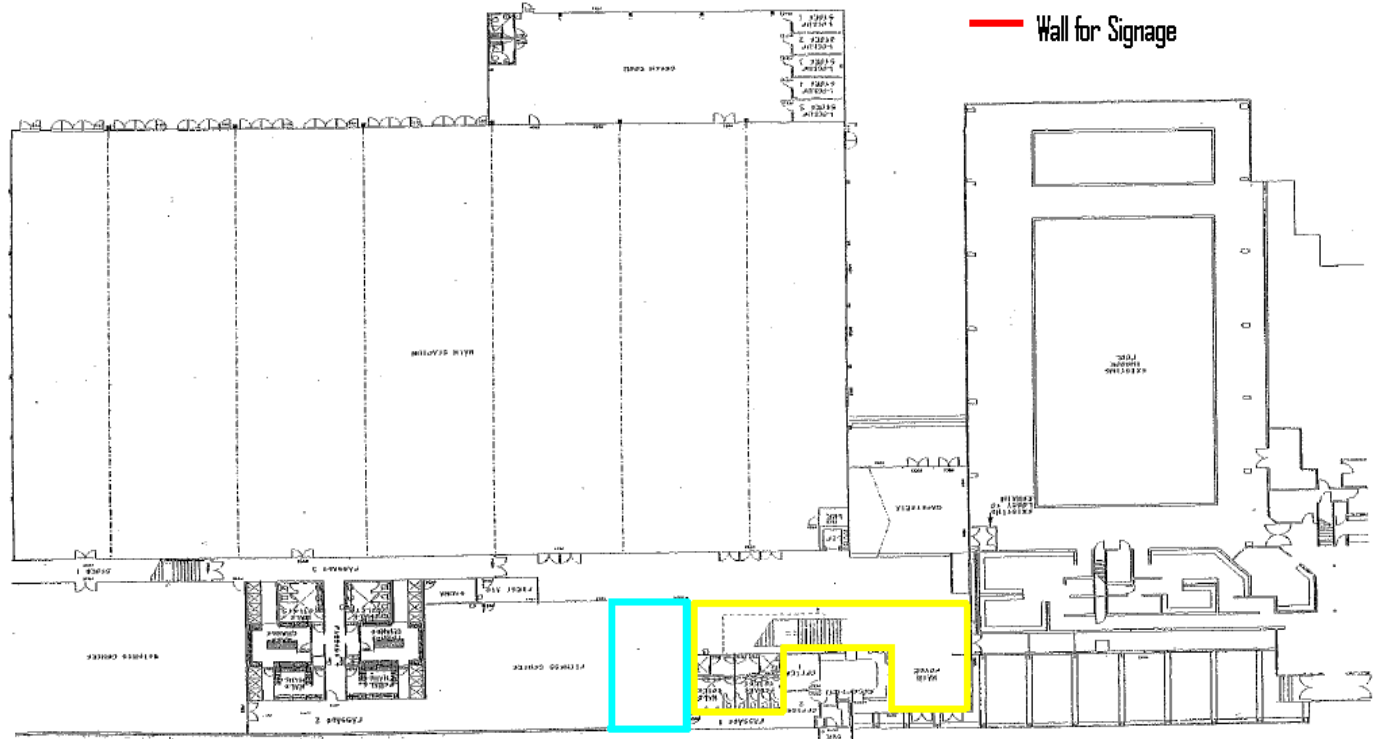

TRAFALGAR CENTRE

Region: Tasman
Venue: **Trafalgar Centre**
Address: Trafalgar Pavilion
Paru Paru Road
Nelson
Phone: 03 539 1301
Fax: 03 548 1018

Multi-purpose sports venue and events centre

Seating Capacity	
Total	1,200
Temporary Seating	120 tiered seats each end of court
TV Setup	Camera cage for 1 camera on mezzanine level courtside (if extended for 2 cameras will lose 6 seats) Media boxes can be used for cameras Boom can be situated at court end

Facilities – Main Stadium	
Courts	2 Sprung wooden floors (natural dark wood) Main court is set off centre of the stadium
Court Markings	Netball lines are green Four other coloured markings on floor
Runoff	Main court setup 8m court end by entrance 4.57m bench side 10m court end far side of stadium 11.5m opposite side to benches Other courts 7.5m by entrance 4.2m between both courts 6.7m far end of stadium 1.3m court end (west side) 1.25m court end (east side)

TRAFALGAR CENTRE

Goal Posts	Sunk on all courts
Scoreboard	2x electronic scoreboards, 1 at each end of the court
Lighting	Sufficient for TV
PA System	Needs connecting for each event
Fixed Signage	No
Ceiling Height	Greater than 8.3m in all areas
Heating	Fan heating in stadium Council restriction - no activation between 8.30-11.30am and 5-6.30pm weeknights
Courtside Media	Media box with window at entrance court end (seats 6) Telephone lines and power available – needs to be activated
Public Access to Seating	Ground level entrance

Changing Rooms	
Changing Room 1-4	2 female, 2 male Clothing hooks Bench seating 3 showers 1 toilet Mirror Hand basin Heater
Disabled Toilet (not for public use)	Sports entrance – East side 1 toilet 1 urinal

TRAFALGAR CENTRE

Meeting Rooms	
Clubrooms/Bar	<p>Approx 150 pax cocktail Can divide into two rooms Lower level of building – east side under bleaches Large room with bar setup Pool table Couches Full kitchen Another small kitchen East side by toilets</p>
Other Rooms	<p>2 connecting rooms Currently used for storage</p>
Function Room – Victoria Room	<p>Approx 350-450 pax cocktail 250 pax dinner seated (tables of 10) Removable stage Dance floor Enclosed courtyard with BBQ tables Full kitchen 1x small female toilet off kitchen 3x female toilets 2x male toilets, 1x urinal East side of Foyer Interconnecting with Public Facilities</p>
Entrance – Pre Function Area	<p>In the foyer of the venue Breaks into 2 areas Used as the Victoria Room pre-function area</p>

Other	
Ticketing	<p>No exclusive ticket agent Ticketek is used for most events Small ticket office with window at the entrance of the venue</p>
First Aid	
Drug Testing	

Public Facilities	
Ladies Toilets	4 ground level in entrance area

TRAFALGAR CENTRE

Men's Toilets	4 toilets, 5 urinals ground level in entrance area
Disabled Toilets	Male and female blocks Ground level In Victory room
Lift	No
Parking	210 within the complex VIP parking can be arranged with stadium
Food outlets	Space to cater for audiences
Catering	No exclusive caterer

Notes:

- Lower seating unit behind the bench cannot be opened due to lack of space. This loses 294 seats

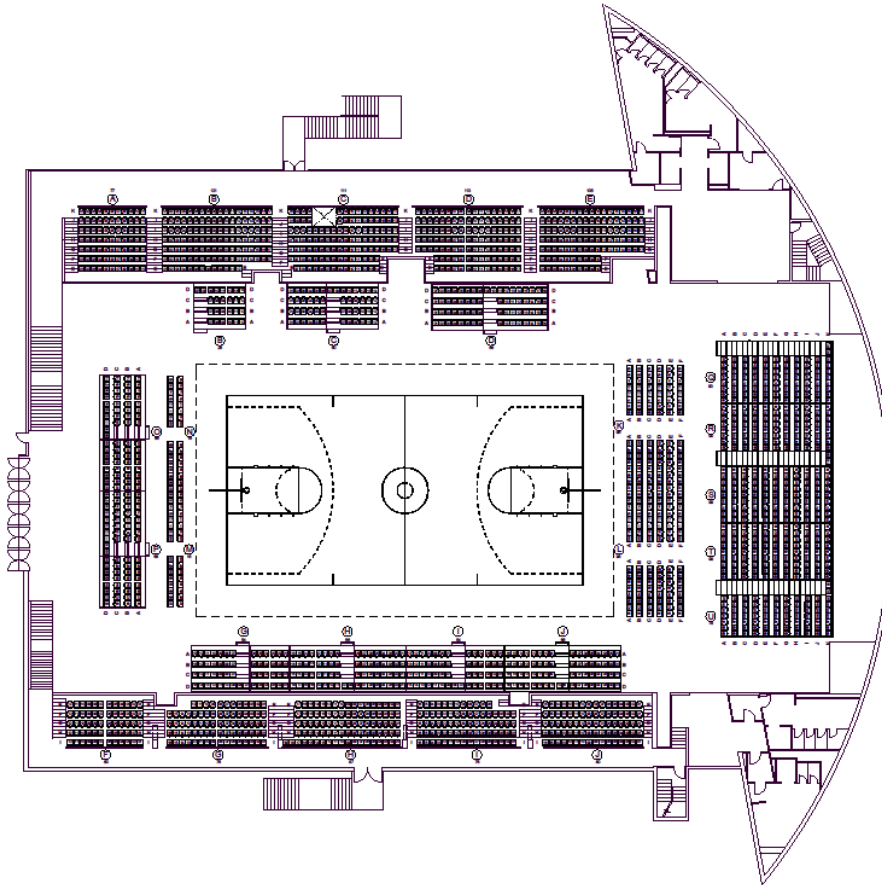

Ph (03) 5466664 Fax (03) 5466692
 PO Box 1325 Nelson

**TRAFALGAR
 CENTRE
 SEATING PLAN**

**COURT SPORTS
 2101**

DRAWN : BR CHECKED :

DATE : 18/12/08

JOB No	SHEET:	REV:
694.8	07	