



NETBALL NEW ZEALAND
Pōitarawhiti Aotearoa

Canterbury Netball

COWLES STADIUM

Region: Canterbury
Venue: **Cowles Stadium**
Address: 170 Pages Road
Christchurch
Phone: 03 941 6852
Fax: 03 941 7541

Multi-purpose sports stadium and events centre

Seating Capacity	
Total	1,291
Bleachers	500 fixed seats Balance of seating to be brought in from outside contractor
Restricted Viewing	Varies depending on setup
TV Setup	Use bleacher side of seating TV commentary box above fixed seating

Facilities – Main Stadium	
Courts	1 centre court Wooden floor (lengthways) Not permanently marked out 2 wooden courts Permanently marked
Court Markings	Current netball markings are red Centre court would need to be laid in white and other court markings taped out
Runoff	1.55m seating to court 1 2.8m court 1 to court 2 1.6m court 2 to wall 2.75m court end to walls Centre court setup would have adequate runoff
Goal Posts	Sunk on both courts Able to be sunk for a centre court

COWLES STADIUM

Scoreboard	2 electronic scoreboards 1 slightly larger that is used on the main court setup
Lighting	1000 lux at courtside (when in a 2-court setup) 1200 lux on centre court
PA System	Hung from ceiling CD playback
Fixed Signage	No
Ceiling Height	Greater than 8.3m on centre court Lower above goal posts on 2 court setup
Heating	Diesel heaters
Courtside Media	Location would depend on seating setup Broadband and power installed as required
Public Access to Seating	Ground level entrance

Changing Rooms

Changing Room 1 and 2	Clothing hooks Bench seating 4 showers 2 toilets Lockable
Referees Changing Room	1 shower 2 toilets

Meeting Rooms

Office	Small room Can be used as a first aid room
Green Room	Lounge area off the main court Kitchen adjacent
Store room	Can be used as a changing room No showers or toilets

COWLES STADIUM

Other	
Ticketing	No exclusive ticket agent No ticket office – use the main reception
First Aid	Use the office
Drug Testing	Use softball pavillion

Public Facilities	
Ladies Toilets	In main foyer area (entrance from stadium)
Men's Toilets	In main foyer area
Disabled Toilets	1 in foyer area
Lift	No
Parking	240 within the complex
Food outlets	No Vending machines in foyer area
Catering	No exclusive caterer Kitchen available adjacent to the green room

Notes:

- Runoff not suitable to be able to run two courts
- Seating not ideal being bleachers instead of actual seats

Plan of Cowles Stadium

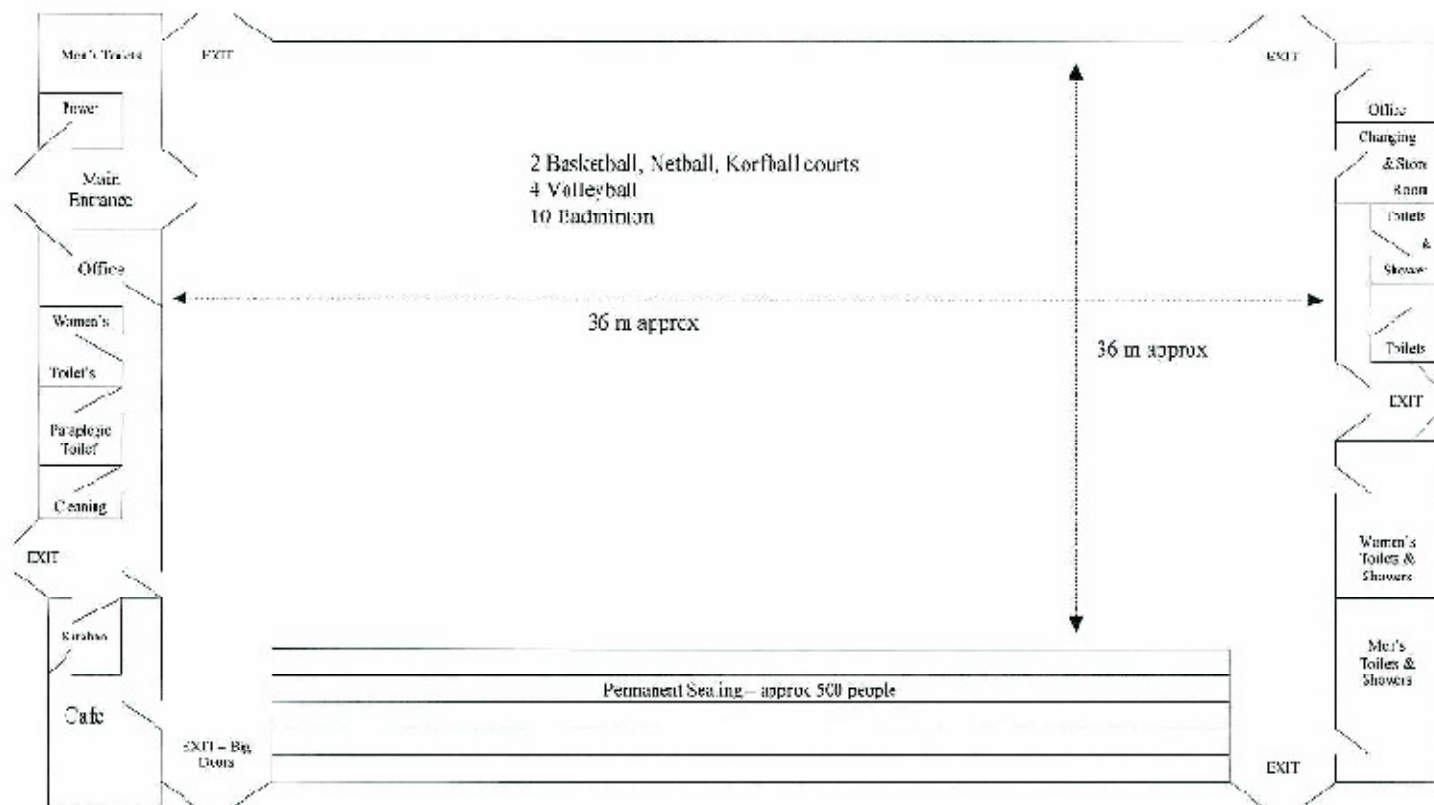

PIONEER STADIUM

Region: Canterbury

Venue: **Pioneer Leisure Centre (Stadium)**

Address: 75 Lyttleton Street
Spreydon
Christchurch

Phone: 03 941 6851

Fax: 03 941 7029

Sports stadium and aquatic centre next to Centennial Park

Seating Capacity	
Total	Varies – no fixed seating on-site Mobile seating of up to 840 seats
Restricted Viewing	Varies depending on setup
TV Setup	Not really suitable for TV Broadcaster would need to do a complete check of the venue

Facilities – Main Stadium	
Courts	3 courts Wooden courts, side-by-side Able to lay a court lengthwise, but costly
Court Markings	Multiple court markings exist Netball lines in blue Courts would need to be taped in white
Runoff	2.75m court 1 to court 2 1.74m court 2 to court 3 2.2m court 3 to wall 3.5m court end to walls
Goal Posts	Sunk on all courts
Scoreboard	3 electronic scoreboards 1 large, 2 small
Lighting	Recently completed an upgrade on lighting

PIONEER STADIUM

PA System	PA system available One system is run from mezzanine area with roving mic for stadium Mobile PA system with CD playback
Fixed Signage	No
Ceiling Height	Greater than 8.3m in all areas
Heating	LPG heating
Courtside Media	Location would depend on seating setup Telephone lines and power installed as required
Public Access to Seating	Floor level entrance

Changing Rooms

Changing Room 1 and 2	Also used by public for gym and aquatic centre Clothing hooks Bench seating 3 showers 1 toilet, 1 disabled toilet Carpeted
Upstairs Changing Room	8-10 pax Clothing hooks Bench seating 2x disabled toilets

Meeting Rooms

Meeting Rooms x3	60 pax each room Mezzanine level Overlooks court Can be made into one big space
Lounge	Away from gallery Separated by kitchenette
Kitchenette	Access to one of the meeting rooms by sliding door Sink, zip, stove

PIONEER STADIUM

Other	
Ticketing	No exclusive ticket agent No ticket office – may have to use the main reception
First Aid	1 room 1 hand basin 1 zip
Drug Testing	Use other rooms

Public Facilities	
Ladies Toilets	In main foyer area
Men's Toilets	In main foyer area
Disabled Toilets	In main foyer area
Lift	Yes
Parking	Approx 250 spaces within the complex
Food outlets	Cafe Vending machines in foyer area
Catering	No exclusive caterer Kitchen available adjacent to the lounge room
Fitness Centre	Public
Aquatic Centre	Public

Notes:

- Seating situation limited. Costly to bring in scaffolding
- Changing rooms cannot be closed off from the public
- Only 1 umpire changing room available with no shower

QEII STADIUM

Region: Canterbury
Venue: **QEII Stadium**
Address: Travis Road
North New Brighton
Christchurch
Phone: 03 941 6849
Fax: 03 941 7182

Multi-purpose sports centre adjacent to fitness centre, squash courts, athletics track and swimming pool complex.

Seating Capacity	
Total	400
Bleachers	400 Also looking to bring in portable seating for a main court setup – approx 1000 seats
Restricted Viewing	Varies depending on setup
TV Setup	Not really suitable for TV

Facilities – Main Stadium	
Courts	3 courts, side-by-side Not able to lay a court lengthwise as posts can't be sunk
Court Markings	White
Runoff	1.4m wall to court 1 2.74m court 1 to court 2 2.74 court 2 to court 3 1.6m court 3 to wall Approx 2.4m court end to walls (poles, walls and doors in the way)
Goal Posts	Sunk on all courts
Scoreboard	3 small electronic scoreboards
Lighting	1,000 lux

QEII STADIUM

PA System	Portable PA system CD playback
Fixed Signage	No
Ceiling Height	Greater than 8.3m in all areas
Heating	No Air conditioning only
Courtside Media	Location would depend on seating setup Telephone lines and power installed as required
Public Access to Seating	Ground level entrance

Changing Rooms

Changing Room 1 and 2	Clothing hooks Bench seating
Squash Court Changing Room 1 and 2	2 levels down Clothing hooks Bench seating 4 showers 2 toilets

Meeting Rooms

Meeting Room	Medium size Kitchenette
---------------------	----------------------------

Other

Ticketing	No exclusive ticket agent No ticket office – may have to use the main reception
First Aid	1 room In main public area
Drug Testing	Use other rooms

Public Facilities	
Ladies Toilets	In main foyer area
Men's Toilets	In main foyer area
Disabled Toilets	In main foyer area
Lift	Yes
Parking	Within the complex
Food outlets	Cafe poolside Vending machines in foyer area
Catering	No exclusive caterer
Physio	Yes
Massage	Yes
Fitness Centre	Operates for the public Fully equipped weight-lifting gym Team gym
Aquatic Centre	25m, 30m and 50m 10 lane pool Public

Notes:

- Access to the courts for public is limited
- Changing rooms not adequate
- No umpire changing room available
- Runoff at court ends is dangerous – doors, walls and poles within 2m of the court

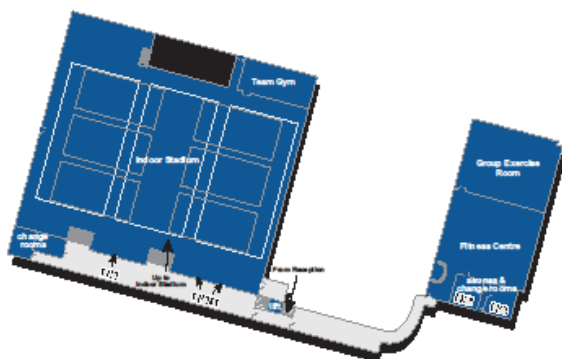

levels 4 & 5

Fitness Centre, Indoor Stadium and Concourse



level 3

Main Entrance and Reception



level 2

Pools, Recreation Room and Delicatessen

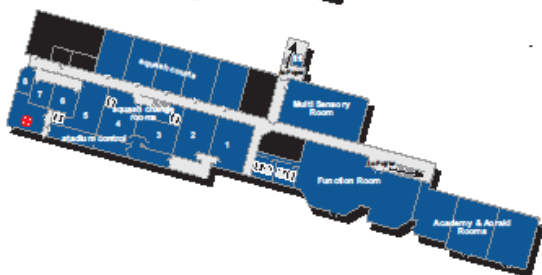

level 1

Squash Courts, Function and Academy Rooms



SBS EVENTS CENTRE

Region: Canterbury
Venue: **SBS Events Centre**
Address: Aorangi Park
Morgans Road
Timaru
Phone: 03 686 0751
Fax: 03 686 0752

SBS Events Centre is a multi-purpose indoor venue and features a large sports hall with fully sprung Canadian maple floor, a fully equipped and professionally staffed fitness centre, a large lounge and various other spaces

Seating Capacity	
Total	1,038
Permanent seating Moveable seating	150 12 units each able to hold 74 pax
Restricted Viewing	None
TV Setup	Not really suitable for TV

Facilities – Main Stadium	
Courts	3
Court Markings	Badminton, basketball, volleyball Netball lines are green Taped in white for NNZ hires
Runoff	Main court setup 3.05 on all sides 3 court setup 3.15m at ends, 4.15m between each court (moveable seating takes up 1m of space on both north and south ends)
Goal Posts	Sunk on all courts
Scoreboard	Yes

SBS EVENTS CENTRE

Lighting	820 lux (last reading)
PA System	Ideal for announcements Wireless microphone Mixing desk for music is controlled from Managers office
Fixed Signage	Multiple Main sponsor is SBS, on court decal laid in centre
Ceiling Height	Above court areas is 9.8m, which lowers to 8m on the outside of the courts
Heating	Ceiling mounted gas heaters
Courtside Media	Limited
Public Access to Seating	Ground level entrance

Changing Rooms	
Changing Room 1-3	2 female, 1 male 25 pax Clothing hooks 4 showers 1 toilet Mirrors
Umpires Changing Rooms x2	1 has a permanent first aid bed

Meeting Rooms	
South Canterbury Finance Lounge	250 pax theatre 23m by 14m (322sqm) First floor Bar area Commercial kitchen adjacent
Coolpak Coolstores Boardroom	15 pax theatre 28sq m Fully air-conditioned

SBS EVENTS CENTRE

Other	
Ticketing	No exclusive ticket agent Could sell tickets from foyer
First Aid	1 bed Could use space in the venue if tenant is approached
Drug Testing	Use other rooms

Public Facilities	
Ladies Toilets	Adjacent to lounge and in main entrance foyer
Men's Toilets	Adjacent to lounge and in main entrance foyer
Disabled Toilets	Adjacent to lounge and in main entrance foyer
Lift	Yes
Parking	620 spaces in Aorangi Park Some provision for coach parking
Food outlets	None onsite 4 Square is opposite venue, 3 min walk
Catering	No exclusive caterer Venue is able to provide upon request
Fitness Centre	Public Fully equipped weight-lifting gym

WESTPAC ARENA

Region: Canterbury
 Venue: **Westpac Arena**
 Address: Jack Hinton Drive
 Addington
 Christchurch
 Phone: 03 363 3300
 Fax: 03 363 3364

Multi-purpose sports venue and events centre

Seating Capacity	
Total	7,362 + corporate boxes Capacity is dependent upon whether seating bank is used court end
Upper Tiers	2,457 – inclusive of club
Lower Tiers	4,468
Loose Floor Seating	437 (1 end)
Corporate Suites	240
Restricted Viewing	1 st and 2 nd rows of top level (due to railing)
TV Setup	Courtside camera does not restrict viewing Need to be mindful of boom camera at court end Court must be centred over V stand

Facilities – Main Stadium	
Courts	1 Sprung wooden floor laid for international matches Need to ensure venue lays it in the correct place for TV (centred over V stand)
Court Markings	White markings for international matches Other court markings are taped out
Runoff	More than 3.05m on all sides 0.5m for signage 2m for benches No crowd access to court level (unless seating bank used court end)
Goal Posts	Sunk

WESTPAC ARENA

Scoreboard	1 electronic scoreboard (cube) centred over court
Lighting	1500 lux
PA System	CD playback
Fixed Signage	Around 2 nd seating tiers of the stadium Light boxes must be off
Ceiling Height	Greater than 8.3m in all areas
Heating	Yes
Courtside Media	Can be accommodated opposite score bench Telephone lines and power installed as required
Public Access to Seating	Several entrances around stadium All entrances upstairs

Changing Rooms	
Changing Room 1-6	1 and 2, 3 and 4 and 5 and 6 interconnecting Clothing hooks Bench seating 3 showers 2 toilets Heating Lockable
Star Dressing Rooms x4	2.7mx3.8m 1 shower 1 toilet 1 makeup mirror and dressing table Referees Ideal for drug testing

Meeting Rooms	
Green Room	Tea and coffee making facilities Couches TV

WESTPAC ARENA

Corporate Boxes x18	16 single – 12 pax each 2 double – 24 pax Need to be purchased separately from Arena
Production Room	Approx 25 pax Kitchenette Suitable for media conference
Boardroom	Approx 20 pax Opposite main offices

Other	
Ticketing	Ticketek exclusive ticket agent Sales onsite
First Aid	1 room 1 bed 1 stretcher 1 wheelchair In concourse of the Arena, near Arena offices
Drug Testing	Use one star dressing room
Laundry	Commercial size laundry facility in dressing room area

Public Facilities	
Ladies Toilets	Mezzanine and ground level
Men's Toilets	Mezzanine and ground level
Disabled Toilets	Mezzanine and ground level
Lift	Yes
Parking	Team car parking at rear of venue VIP car parking available Approx 300 free public spaces
Food outlets	SSL Catering
Catering	Exclusive caterer SSL Catering

WESTPAC ARENA

Notes:

- Retractable seating only to be used at load-in end of the court
- Corporate boxes can be utilised courtside (dependent on court end seating)

NCC Approval

Client Approval

Date

Building consent 4882027 and the engineer's notes
 refer to all seating capacity details
MAXIMUM USABLE SEATS = 6888

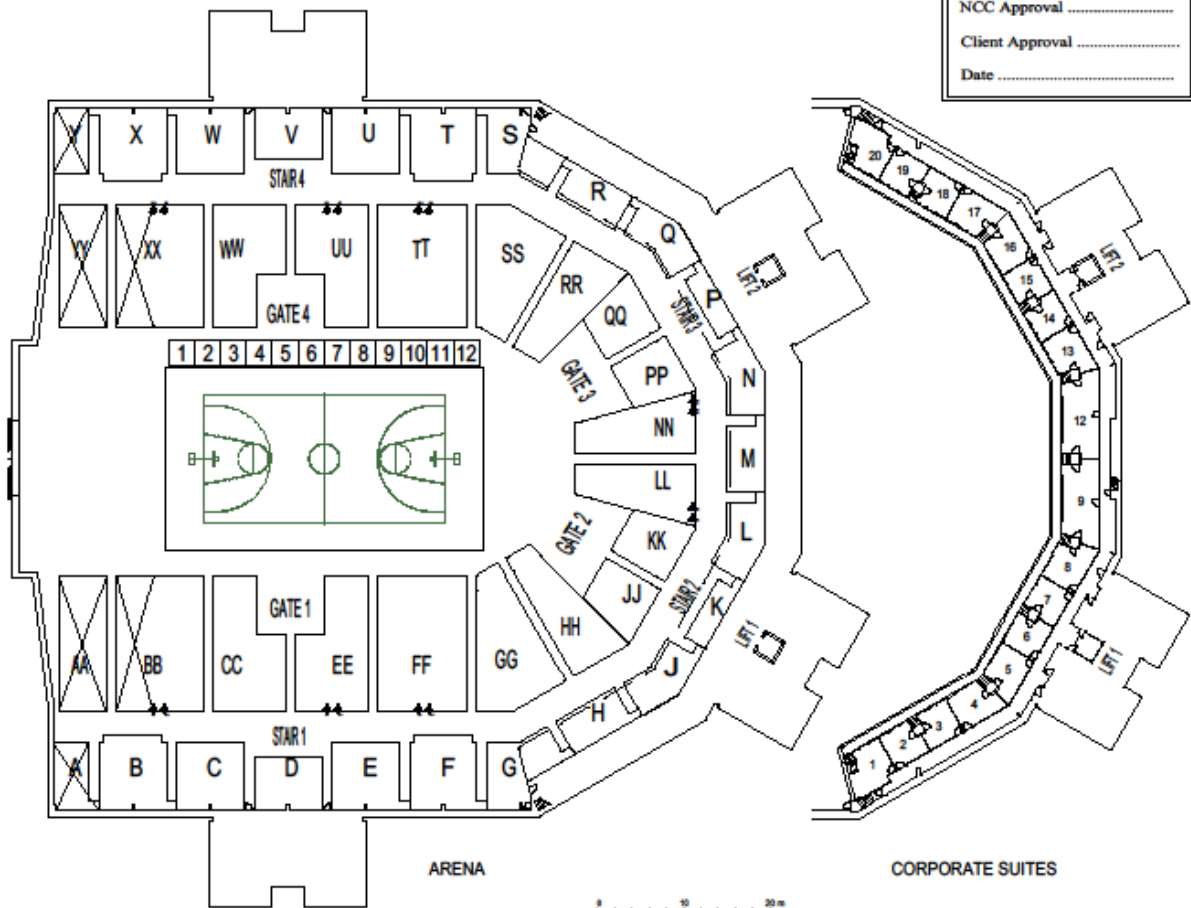

Rev	Date	Issue	Version
			2
Venue			
Westpac Centre			
Client			
NCC(NZ)Ltd			
Subject			
Flames 2005			
Drawn	By	Date	
Scale	Drawn	Client file	
Unavailable		Event Capacity	